

CERTIFIED LAND CORNER RECORDATION

DESCRIPTION OF CORNER EVIDENCE FOUND, AND ORIGINAL RECORD (if known)

LOCATION Found 3/4" dia. x 18" long iron pipe, 4" below prairie surface.
 CW 1/16
 S.21
 T.14N., R.66W.
 6th P.M.

DESCRIPTION OF MONUMENT AND ACCESSORIES ESTABLISHED
 TO PERPETUATE THE ORIGINAL LOCATION OF THIS CORNER:

Replaced found monument by 1 1/2" dia. x 30" long iron pipe with brass cap.
 Dug pit, 2' x 2' x 1' deep, 2.5 feet south.
 Raised earth mound, 2' x 2' x 1' high, 2.5 feet north.
 Left pipe as memorial.

SKETCH, WITH COURSE AND DISTANCE TO ADJACENT CORNER IF DETERMINED IN THIS SURVEY.
 (May Sketch or Paste Reproduction on Reverse Side.)

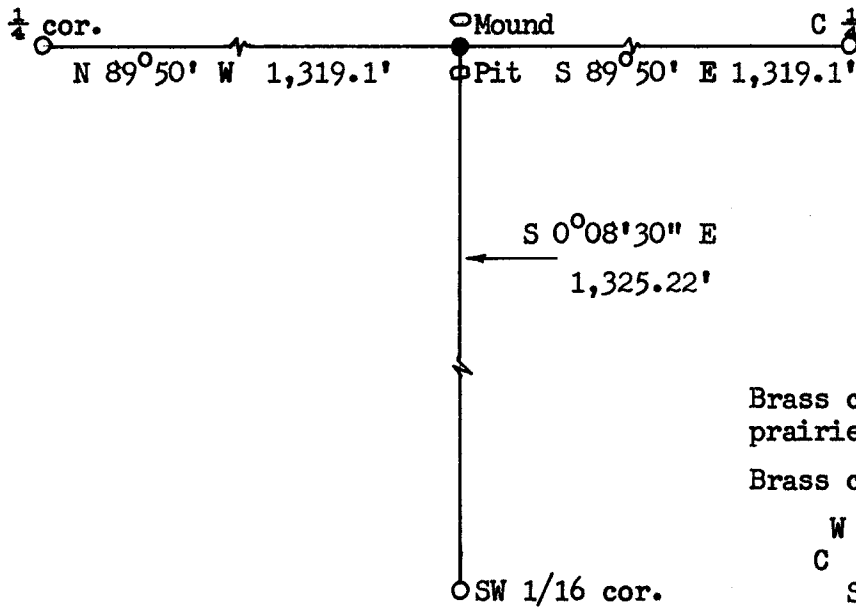

Brass cap set 6" above prairie surface.

Brass cap stamped:

W 1/16
 C - C
 S.21

LS 519 1972



I, R.L. Hudson certify that I have carefully performed ~~or reviewed~~ the work done on the diagrammed corner as reported on this recordation form and approve the same.

R.L. Hudson
 Signature of Surveyor

Wyoming L.S. No. 519
 Registration No.

STATE OF WYOMING,
 Office of Clerk and Recorder,
 County of _____

This "corner record" was filed for record on the 23rd day of May, 19 72, was noted on the cross-index plat and is assigned page No. 14-66, in book No. ONE.

John B. Hillman KW
 County Official

Cross Index No. _____	T. _____	R. _____	Mer. _____
_____	T. _____	R. _____	Mer. _____
_____	T. _____	R. _____	Mer. _____
_____	T. _____	R. _____	Mer. _____
_____	T. _____	R. _____	Mer. _____
_____	T. _____	R. _____	Mer. _____
_____	T. _____	R. _____	Mer. _____

The State of Wyoming }
County of Laramie } SS

This instrument was filed for record
at 9:18 o'clock A. M. on the
23rd day of May
A. D. 19 72 and duly recorded in
Book on page

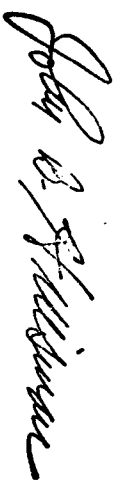

County Clerk & Ex-Officio Register of Deeds
By _____ Deputy